

Data Sheet Ergotech 650/1000- Multi

Model description		Ergotech 650/1000 - 3300 Ergotech 650/1000 - 5200 Ergotech 650/1000 - 8000
International size code		6500 - 3300 6500 - 5200 6500 - 8000
Clamping unit		6500
Clamping force	kN	6500
Locking force	kN	7150
Max. mould opening stroke	mm	930
Min. mould mounting height	mm	450
Max. mould mounting height	mm	950
Max. daylight between platens	mm	1880
Overall size of platens	h x v	mm
Daylight distance between tie bars	h x v	mm
Max mould weight	kg	8600
Max weight content on moving platen	kg	5700
Hydraulic Ejector		
Ejection stroke	mm	300
Ejection force	kN	138
Ejector retraction force	kN	58

Data Sheet Ergotech 650/1000 - Multi

Injection unit		3300 h			
Screw cylinder		Standard			Special
Screw diameter	mm	70	80	95	80
L / D - Ratio		23	20	20	24
Injection pressure (at 400 °C)	bar	2423	1855	1316	1855
Cylinder head volume	cm ³	1362	1779	2509	1779
Shot weight in (PS)	g	1230	1600	2260	-
Shot weight in (PE)	g	-	-	-	1260
Max. metering stroke	mm	354			
Max. dist. of nozzle retraction	mm	720			
Nozzle dipping depth (SVO)	mm	45 (30 for SPI)			
Nozzle sealing force	kN	110			
Heating capac. of screw cylind.	kW	30.6	30.6	42.6	43.0
Electrical screw drive (WA)	kW	40			
Hopper capacity	Ltr.	110			
General Data		650/1000 - 3300			
Oil tank capacity	Ltr.	1300			
Pump unit	kW	74 / 90			
Total installed electrical rating	kW	105 / 121 *** +EE2	105 / 121 *** +EE2	117 / 133 *** +EE2	117 / 133 *** +EE2
Number of dry cycles to EUROMAP 6		4,20s-700mm / 3,90s-700mm			
Net weight (without oil) Clamping unit / Injection Unit	kg	25700 / 7100 +EE2			
Machine dimensions L x W x H	m	10.1* x 2.5 x 2.6			
Contiuous sound pressure level	dB (A)	70**			

*) without extension of injection unit, see chap. 2.2

***) Operator side measured to EN 201 - annex D, see chap. 3.1.6

Data Sheet Ergotech 650/1000 multi – continued

Injection Unit		430r		
Screw cylinder				
Screw diameter	mm	35	40	
L / D - Ratio		20	20	
Injection pressure (at 400 °C)	bar	2640	2020	
Cylinder head volume	cm ³	168	231	
Shot weight in (PS)	g	149	205	
Max. metering stroke	mm	175	184	
Max. dist. of nozzle retraction	mm	555		
Nozzle dipping tiefe (SVO)	mm	25	25	
Nozzle sealing force	kN	30		
Nozzle distance horizontal max.	mm	300 **)		
Nozzle distance horizontal min.	mm	100 **)		
Displacement adjustment manual horizontal max.	mm	200		
Heating capac. of screw cylind.	kW	9,4	11,1	
Hopper capacity	Ltr.	20		
Net weight (without oil)	kg	1016	1030	

*) as far as the long machine axis

***) from the fixed platen

D	d	L1	L2	Stück
M24	-	50	71	196
M16	-	40	54	18
-	-	-	-	-
-	-	-	-	-
-	-	-	-	-

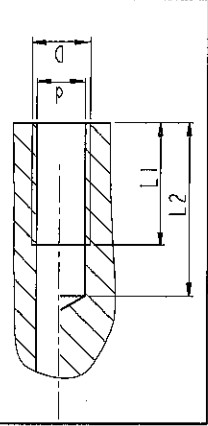

Für Führungsstange
Auswerferplatte
for guide bar of
ejector plate

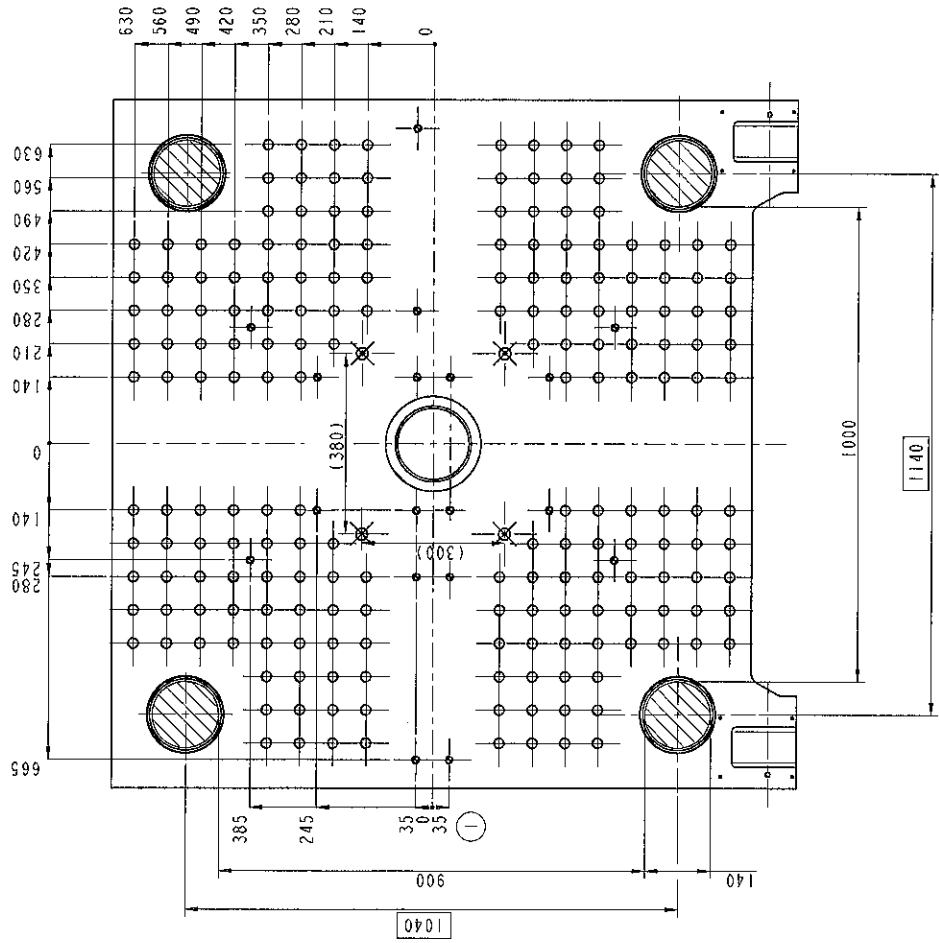
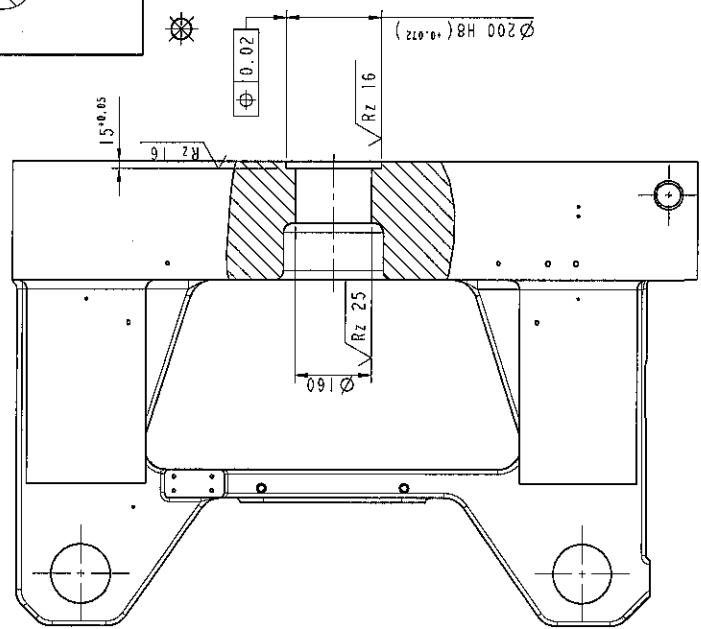

√ (√Rz 16 √Rz 25)

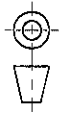

Stk-Nr.	418048	06-12-04	Druck	1	2	3	4	5	6	7	8	9	10	11	12	13	14	15	16	17	18	19	20
Formel	AZ																						
Erstellt	deck																						

Stk-Nr.	418048	06-12-04	Druck	1	2	3	4	5	6	7	8	9	10	11	12	13	14	15	16	17	18	19	20
Formel	AZ																						
Erstellt	deck																						

Stk-Nr.	418048	06-12-04	Druck	1	2	3	4	5	6	7	8	9	10	11	12	13	14	15	16	17	18	19	20
Formel	AZ																						
Erstellt	deck																						

Demag Plastics Group

72363165

ET 50

418115602

3:100

5058kg

88865265

418115602

ET 50

72363165

Demag Plastics Group

72363165

ET 50

418115602

3:100

5058kg

88865265

418115602

ET 50

72363165

Demag Plastics Group

72363165

ET 50

418115602

3:100

5058kg

88865265

418115602

ET 50

72363165

Demag Plastics Group

72363165